



**Regional District of Okanagan-Similkameen**

101 Martin Street, Penticton, BC V2A 5J9  
Phone: (250)492-0237 Fax: (250)492-0063  
Toll Free: 1-877-610-3737  
Website: www.rdos.bc.ca

# PARCEL MAP

Created on: 04-Aug-2023



### LEGEND

- Electoral Area Boundaries
- Parks

**Owner(s):** LEPKE NORMA  
LEPKE WALDEMAR

**Scale** 1:1128

**Civic Address(es):**  
108 MISSEZULA LK RD

**Zoning:**  
Designation: RS1  
Bylaw Number: 2498

**BC Assessment:**  
Assessed Land Value: \$238,000.00  
Assessed Imp. Value: \$282,000.00  
Total Assessed Value: \$520,000.00

**Property Details:**  
Primfolio: 71701033.625  
Folio: 01033.625  
Jurisdiction: 717  
PID: 004-188-080  
Parcel Area (m2): 1,237.63  
Electoral Area: H

Legal Description: *108 Missezula Lake Road*  
LOT 16, PLAN KAP29782,  
DISTRICT LOT 1909,  
KAMLOOPS DIV OF YALE LAND  
DISTRICT

# HARDWOODS®

Materials That Inspire

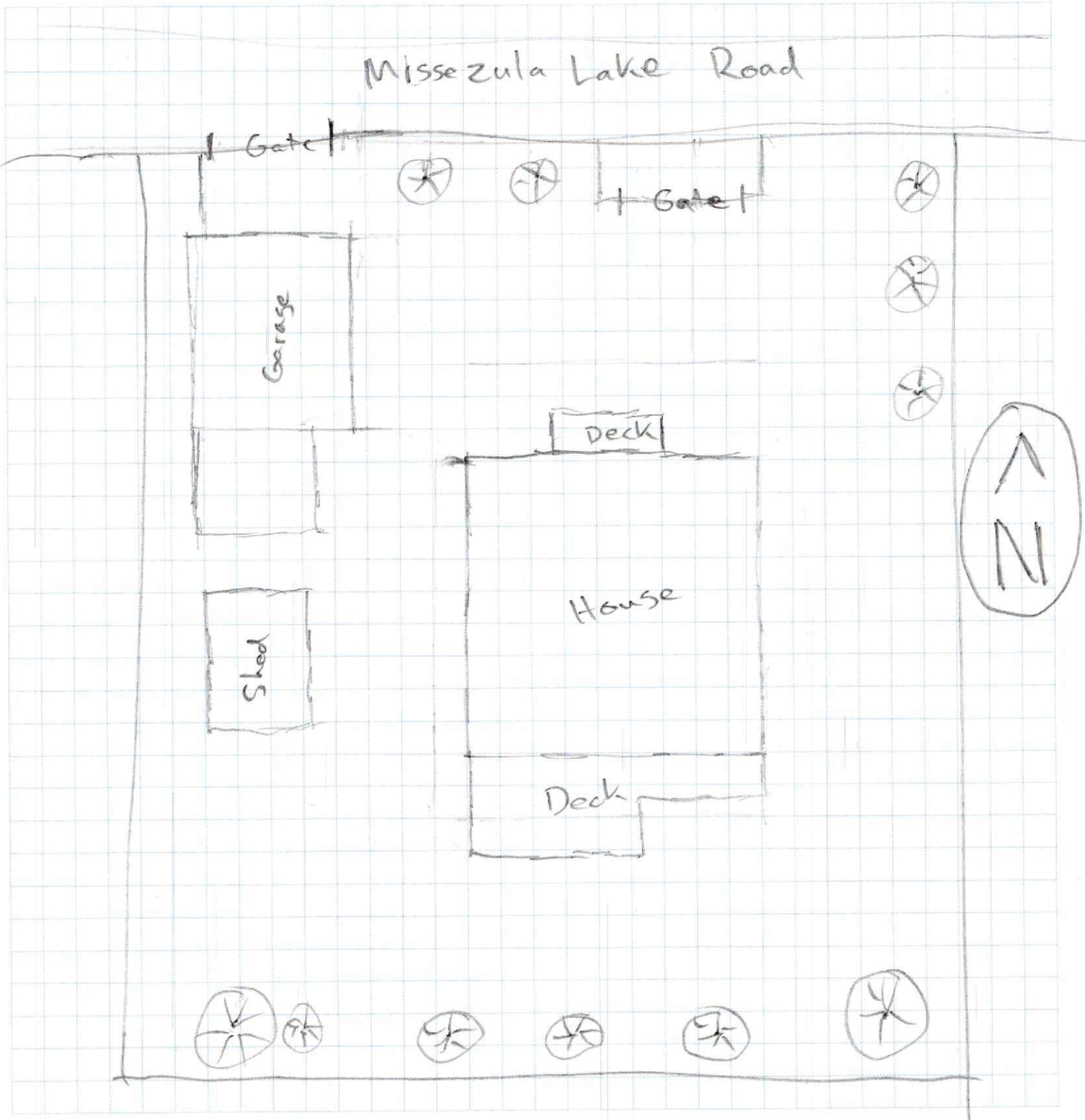

• VICTORIA, BC  
250-715-1485

• VANCOUVER, BC  
604-856-1111

• KELOWNA, BC  
250-491-7677

• CALGARY, AB  
403-236-9100

• EDMONTON, AB  
780-455-5111

• SASKATOON, SK  
306-244-8081

• WINNIPEG, MB  
204-633-6150

• TORONTO, ON  
905-792-6600