

WORKMAN PLACE

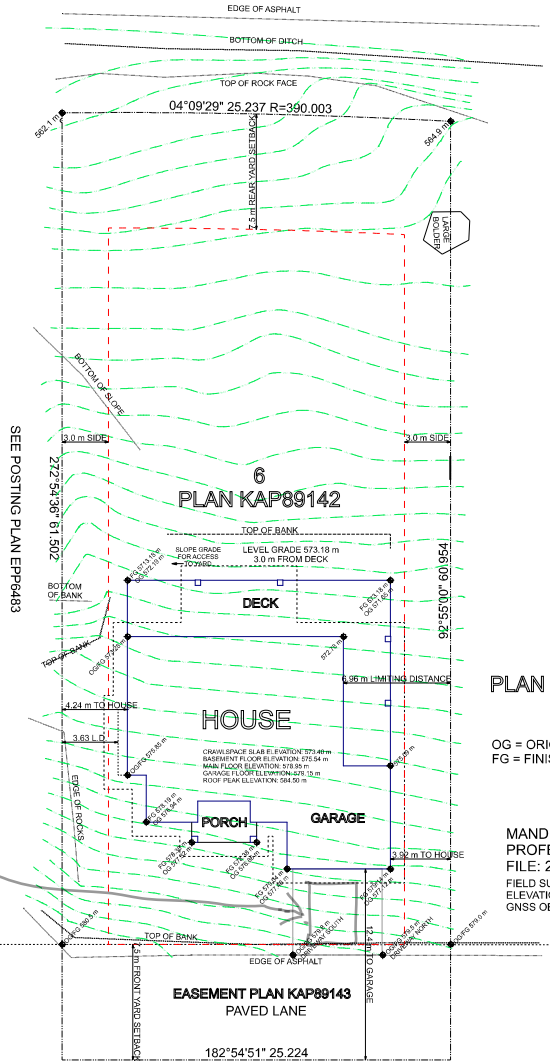

SITE PLAN
 SCALE: 1:150
 CIVIC ADDRESS: 2720 WORKMAN PLACE, NARAMATA, B.C.
 LEGAL DESCRIPTION: LOT 6, DL 207, SDYD, PLAN KAP89142
 PID: 027-935-671
 ZONING: RS1 LOW DENSITY RESIDENTIAL
 LOT AREA: 1548.0 m.sq.
 MAXIMUM PARCEL COVERAGE: 35%
 PROPOSED PARCEL COVERAGE: 280 m.sq. (18.1%)
 REQUIRED SETBACKS: FRONT 7.5 m; SIDE INTERIOR 3.0 m; REAR 7.5 m
 MAXIMUM BUILDING HEIGHT: 10.0 m
 PROPOSED BUILDING HEIGHT: 8.8 m

OG = ORIGINAL GRADE
 FG = FINISHED GRADE

MANDEVILLE LAND SURVEYING INC.
 PROFESSIONAL B.C. AND CANADA LAND SURVEYORS
 FILE: 20-232
 FIELD SURVEY COMPLETED THIS 14th DAY OF NOVEMBER, 2020.
 ELEVATIONS ARE GEODETIC (ORTHOMETRIC HTV2.0) DERIVED FROM
 GNSS OBSERVATION AND PRECISE POINT POSITIONING (PPP)



THESE CONSTRUCTION DOCUMENTS
 HAVE BEEN PREPARED IN
 ACCORDANCE WITH THE
 2018 B.C. BUILDING CODE.

**COPYRIGHTED DOCUMENTS
 ILLEGAL TO REPRODUCE**
 THESE PLANS ARE THE COPYRIGHTED PROPERTY
 OF GROUX DESIGN GROUP INC. AND HAVE BEEN
 LICENSED TO THE ORIGINAL PURCHASER FOR
 THE CONSTRUCTION OF ONE BUILDING.
 IT IS UNLAWFUL TO REPRODUCE THESE
 DOCUMENTS WITHOUT WRITTEN PERMISSION
 IN THE FORM OF A LICENSE AGREEMENT.

SHAW RESIDENCE
 BARNETT CONSTRUCTION
 10000 100th Street
 NARAMATA, B.C.
 DESIGN BY:
 DRAWN BY:
 DATE: 3/31/21
 REVISED:

Groux Design Group Inc. - 100% All Rights Reserved
 Reproduction of these drawings, in whole or in part, including any third party
 information, without the written consent of Groux Design Group Inc. is prohibited. The accuracy of these
 drawings is not guaranteed. Groux Design Group Inc. is not responsible for the construction of the building
 or any structural problems that may arise as a result of the drawings. The drawings are provided for informational
 purposes only and do not constitute a contract.

As a condition of registration, the building designer shall maintain a record of all
 drawings and specifications for the building project. The building designer shall
 be liable for the accuracy of the drawings and specifications. The building designer
 shall be liable for the accuracy of the drawings and specifications. The building
 designer shall be liable for the accuracy of the drawings and specifications. The
 building designer shall be liable for the accuracy of the drawings and specifications.

GROUX DESIGN GROUP
 Custom Home and Building Design Since 1992.
 Groux Design Group Inc.
 phone: 250-279-6378, e-mail: contact@grouxdesigngroup.com
 web: www.grouxdesigngroup.com

WP-5653
 SHEET NO. A1

www.grouxdesigngroup.com - www.westhomeplanners.com - www.houseplanners.com - www.houseplanners.com

Site Plan