

← ASH STREET →

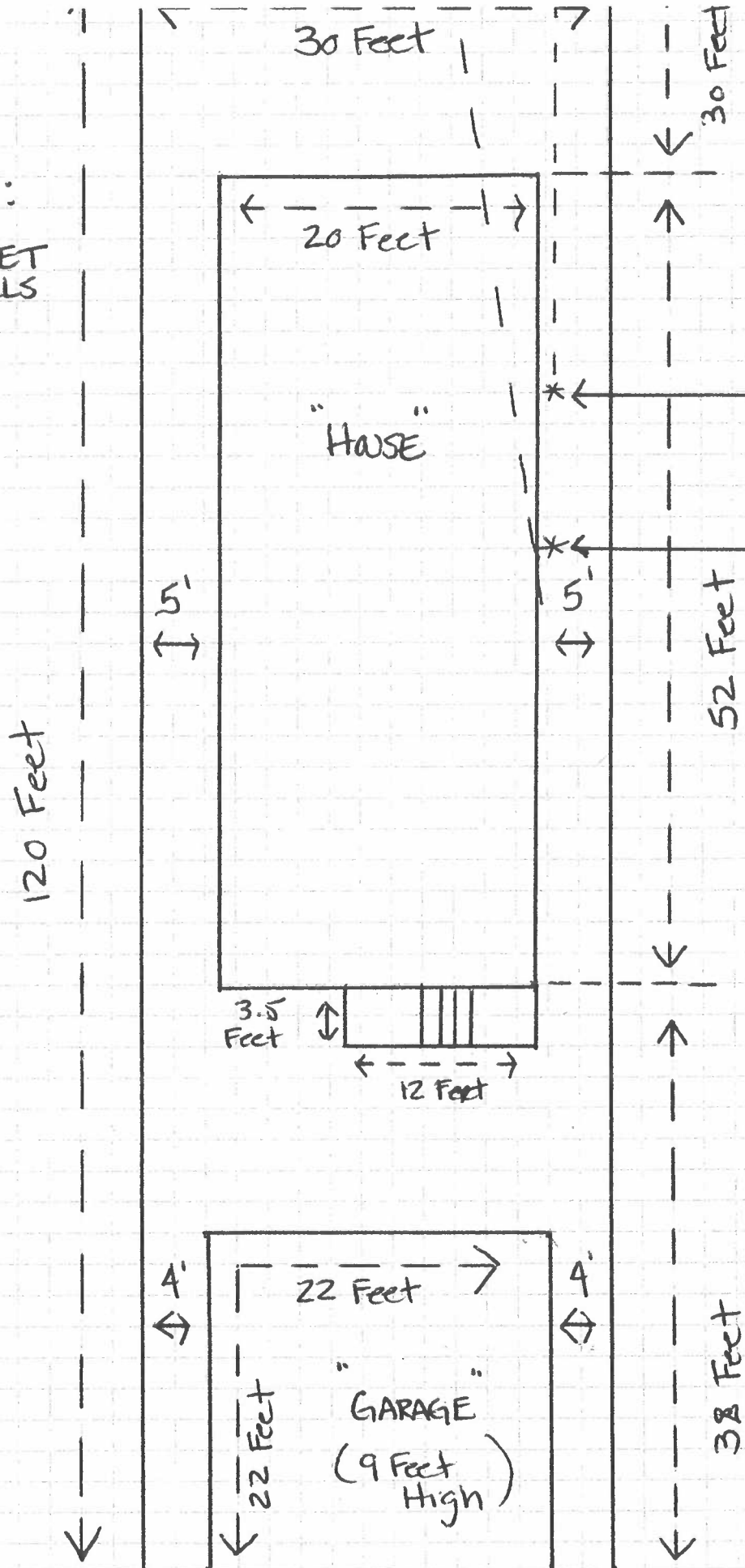

* CIVIC ADDRESS:
1133 ASH STREET
OKANAGAN FALLS
BC CANADA
V0H 1R0



LANE ACCESS

Size - 22' W : 22' Deep

Walls - 9' high.

Construction - 2x4

Roof Pitch - 5/12

Roof Material - Shingles

Soffit Overhang - eave side - 12"
- gable side - 12"

Physical Address - 1133 Ash St. OK Falls BC V0H 1R0

Garage Door Size - 16' wide : 8' high
- opener - yes
- white door - yes

Main Door - Steel - 34" wide : 80" high

Windows - None \emptyset

C fascia Boards - eave - 2x4
- gable - 2x4

Siding - yes

Soffit - yes.

Insulated - yes.