

PROPOSED SUBDIVISION PLAN OF LOT 1, DL's 2450s AND 4104s, SDYD, PLAN EPP134209

PURSUANT TO SECTIONS 67 LTA
BCGS 82E.003

CLIENT: DAN SCOTT
VERSION #1
NOVEMBER 29, 2023

DATUM NAD83(CRS) 2002.0
UTM ZONE 11
UTM NORTHING 5431067.30
UTM EASTING 320014.88
ABSOLUTE ACCURACY 0.07

- LEGEND**
- DENOTES STANDARD CAPPED POST FOUND
 - DENOTES STANDARD IRON POST FOUND
 - DENOTES STANDARD IRON POST FOUND
 - DENOTES INTERNATIONAL BORDER MONUMENT (OBELISK) FOUND
 - DENOTES NON-STANDARD POST (4cm diam ROUND) FOUND
 - ▲ DENOTES TRAVERSE HUB FOUND
 - + DENOTES UNMONUMENTED MEASURED POINT
 - NF DENOTES NOTHING FOUND

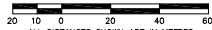

ALL DISTANCES SHOWN ARE IN METRES
THE INTENDED SIZE OF THIS PLAN IS 560 mm
IN WIDTH BY 864 mm (IN HEIGHT) (0 SIZE)
WHEN PLOTTED AT A SCALE OF 1:1000



GRID BEARINGS ARE DERIVED FROM GNSS DUAL
FREQUENCY OBSERVATIONS AND ARE REFERRED
TO THE CENTRAL MERIDIAN OF UTM ZONE 11.
TO OBTAIN LOCAL ASTROMERIC BEARINGS REFERRED
TO THE MERIDIAN THROUGH THE TRAVERSE HUB
LABELLED "SPK3226", SUBTRACT 1° 51' 29".

THIS PLAN SHOWS HORIZONTAL GROUND-LEVEL DISTANCES
UNLESS OTHERWISE SPECIFIED. TO COMPUTE GRID DISTANCES
MULTIPLY GROUND-LEVEL DISTANCES BY THE AVERAGE
CORRECTION FACTOR OF 0.999642. THE AVERAGE CORRECTION
FACTOR HAS BEEN DETERMINED BASED ON AN ELLIPSOIDAL
ELEVATION OF 279 METRES.

THE UTM COORDINATES AND ESTIMATED ABSOLUTE ACCURACY
ACHIEVED ARE DERIVED FROM GNSS DUAL FREQUENCY
OBSERVATIONS USING NATURAL RESOURCES CANADA PPP SERVICES.



ALL DISTANCES SHOWN ARE IN METRES
SCALE OF ENLARGEMENT IS 1:400
AT INTENDED PLOT SIZE OF PLAN

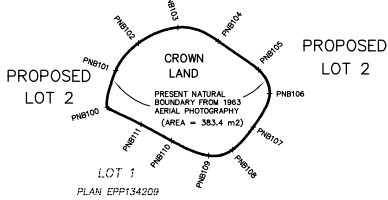

**NATURAL BOUNDARY
TABLE OF COORDINATES
(INTERIOR CROWN LAND LOOP)**

POINT NUMBER	NORTHING	EASTING
PBN100	5430428.3	320227.9
PBN101	5430434.3	320229.3
PBN102	5430438.7	320232.9
PBN103	5430441.3	320239.4
PBN104	5430438.1	320246.0
PBN105	5430434.4	320252.6
PBN106	5430430.5	320256.4
PBN107	5430425.0	320251.7
PBN108	5430421.4	320246.4
PBN109	5430425.4	320244.4
PBN110	5430425.8	320238.4
PBN111	5430425.5	320233.4

THIS PLAN LIES WITHIN THE REGIONAL DISTRICT
OF OKANAGAN SIMLAKAMEN.

THIS PLAN LIES WITHIN THE
JURISDICTION OF THE APPROVING
OFFICER FOR THE MINISTRY OF
TRANSPORTATION AND INFRASTRUCTURE
MOTI FILE

