

CUSTOM PRINT

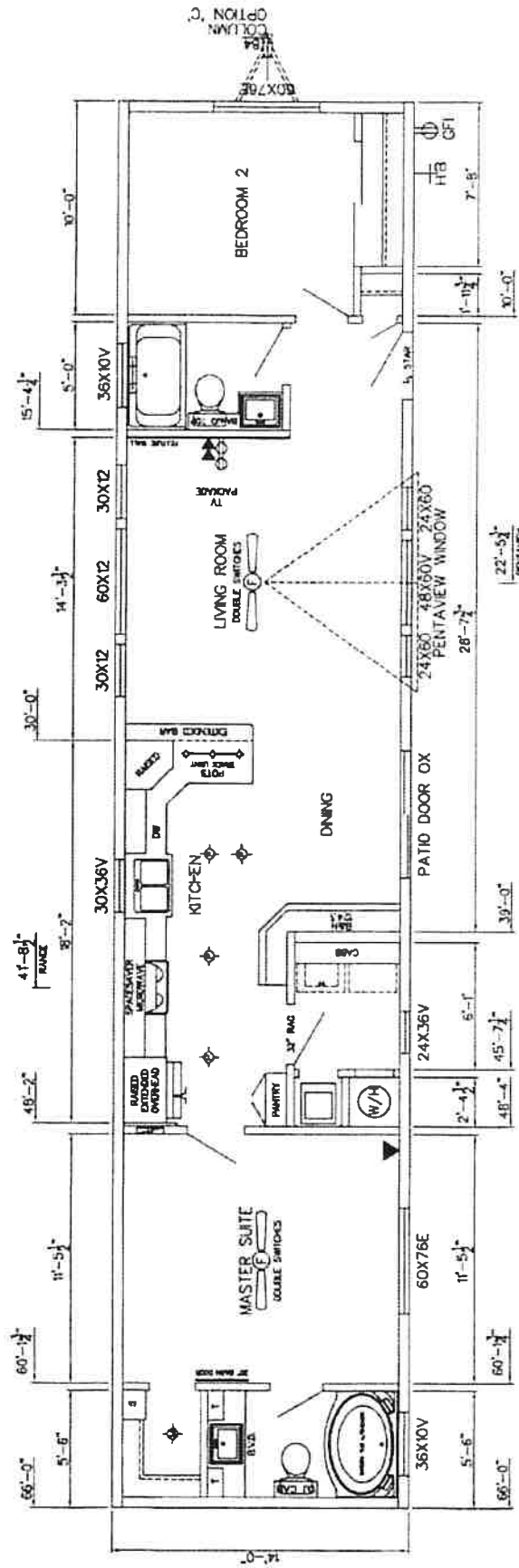

NOTES: MODULE ASSUMES NO RESPONSIBILITY FOR
 FIRE SEPARATION, SEISMIC, OR DOOR/WINDOW
 PENETRATION REQUIREMENTS. CONSULT YOUR LOCAL
 BUILDING OFFICIAL OR ENGINEER OF RECORD TO CONFIRM.

MODULE PENTICTON
 P.O. BOX 190
 1170 RAILWAY STREET
 PENTICTON, B.C. V8E 0S5
 (250) 611-8121

CUSTOMER: _____
 DEALER: _____
 DATE: _____

A
 B
 C

DEALER CHANGE REQUEST

TITLE: A003451
 DRAWING NO: Q13065 - 14C06601
 DRAWN BY: JBT
 DATE: 11-05-20

SERVICE DROPS		FROM SMALL HTON END	FROM SMALL MARRIAGE
DRAIN			
WATER			
ELECTRICAL			
SNOW LOAD CALCULATIONS			
SNOW LOAD CALCULATED AT: 52 PSF DESIGN LOAD			
THIS DRAWING IS INTENDED TO SHOW THE PERIMETER OUTLINE AND OVERALL DIMENSIONS, STEEL FRAME AND BEARING POST LOCATIONS FOR SERVICE DROPS ARE ALSO GIVEN. THIS DRAWING & RELATED DRAWINGS ARE GIVEN AS A GUIDE ONLY FOR THE DESIGN AND CONSTRUCTION OF THE SUPPORTING STRUCTURE. THE DESIGNER HAS THE RESPONSIBILITY FOR THE DESIGN OR CONSTRUCTION OF BEAMS, NO RESPONSIBILITY FOR THE DESIGN OR CONSTRUCTION OF THE SUPPORTING STRUCTURE. THE DESIGNER HAS THE RESPONSIBILITY FOR THE DESIGN OR CONSTRUCTION OF BEAMS, NO RESPONSIBILITY FOR THE DESIGN OR CONSTRUCTION OF THE SUPPORTING STRUCTURE. THE DESIGNER HAS THE RESPONSIBILITY FOR THE DESIGN OR CONSTRUCTION OF BEAMS, NO RESPONSIBILITY FOR THE DESIGN OR CONSTRUCTION OF THE SUPPORTING STRUCTURE.			

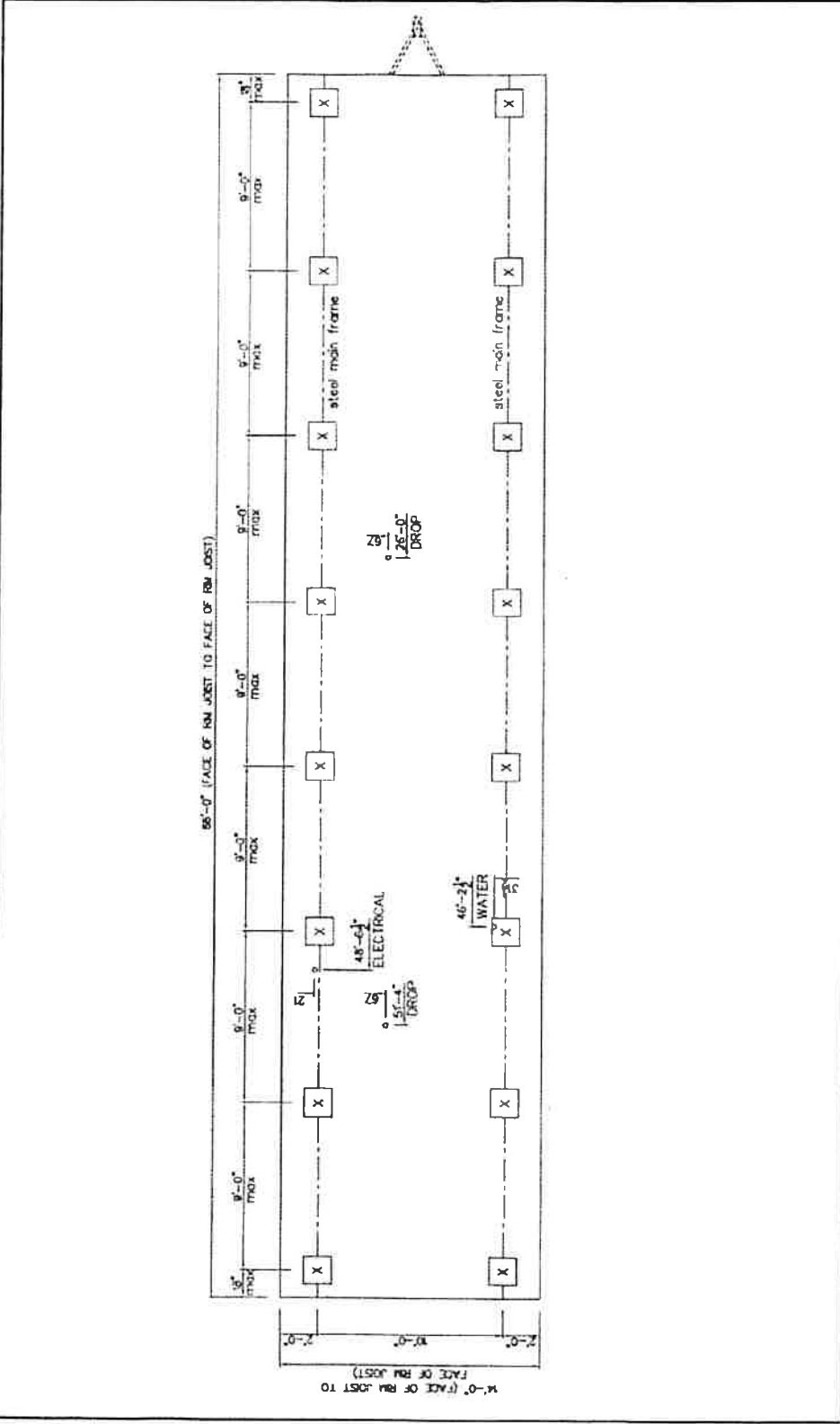

FOUNDATION PLAN		DATE	DATE
NO. REVISED	NO. REVISED	NO. REVISED	NO. REVISED
DRAWN BY: J.B.T.		DATE: 11-05-20	
CHECKED BY:		CHECKED BY:	
MODULE INDUSTRIES - PENTACON 710 HOUSTON STREET PENTACON, S.C. V2A 6K3 (252) 493-0123			
DATE: 11-05-20	NO. REVISED:	NO. REVISED:	NO. REVISED:
FOUNDATION PLAN	FOUNDATION NO. Q13065	FOUNDATION NO. Q13065	FOUNDATION NO. Q13065
DATE: 11-05-20	NO. REVISED:	NO. REVISED:	NO. REVISED:
FOUNDATION PLAN	FOUNDATION NO. Q13065	FOUNDATION NO. Q13065	FOUNDATION NO. Q13065
DATE: 11-05-20	NO. REVISED:	NO. REVISED:	NO. REVISED:
FOUNDATION PLAN	FOUNDATION NO. Q13065	FOUNDATION NO. Q13065	FOUNDATION NO. Q13065

NOTE: NO ALLOWANCES HAVE BEEN MADE FOR THE PERIMETER BLOCKING AT THE MARRIAGE LINE. AN ADDITIONAL 1/2" PER FLOOR IS SUGGESTED TO ALLOW FOR VARIATIONS DURING SET-UP. CONTACT YOUR RETAILER OR SET-UP CREW FOR REQUIRED ALLOWANCES.

PLEASE NOTE: PERIMETER BLOCKING AS PER MANUFACTURER'S SET-UP MANUAL FOR SITE LOAD REQUIREMENTS GREATER THAN 40 lbs/sq ft.

CONSULT YOUR ENGINEER OF RECORD, LOCAL JURISDICTION OR GOVERNING BODY FOR LOCATION SPECIFIC DESIGN LOAD REQUIREMENTS.

4" Thick Slab
10mil 16" grid

10 m rebar - 16" x 16"
grid

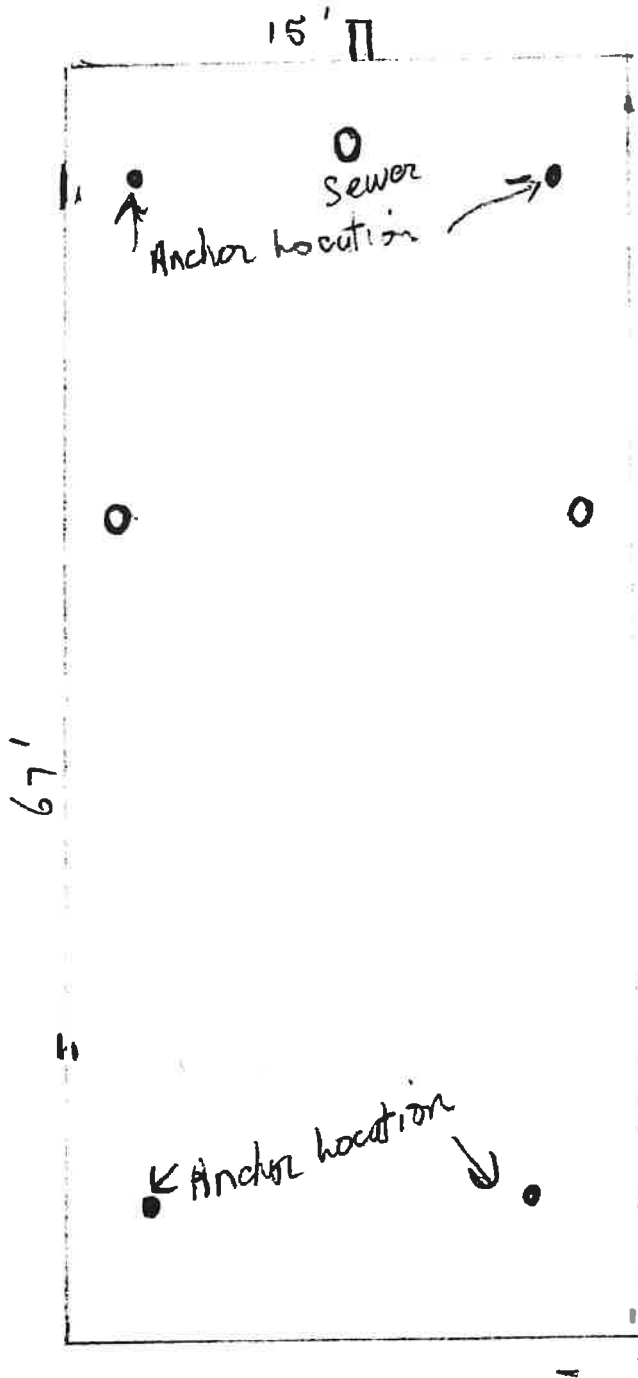

2 set of
TopoRay Stairs
built from treated
wood.